

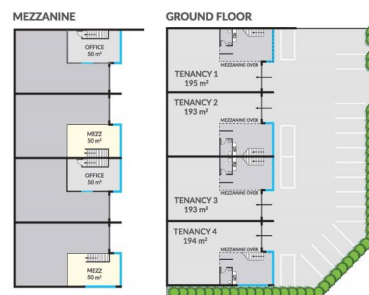

FLOOR PLAN



4/55 Crn Edison Crescent & Strong Street, Baringa QLD

FULLY FITTED OUT OFFICE | BRAND NEW COMPLEX

David Goldsworthy from Ray White Commercial Northern Corridor Group is pleased to present to the market Unit 4 at 55 Edison Crescent, Baringa for lease.

With the customer in mind, this unit was purposely designed to give all units exposure and provide superior access for business operations.

FEATURES:

- 194m2 warehouse + 50m2 mezzanine
- Fully fitted out office on mezzanine level (carpet, air conditioned, data and power points)
- High clearance roller doors

For more information or to arrange a tour of Aura Business Park, please contact exclusive marketing ag

Industrial
FOR LEASE

244sqm

Ray White

David Goldsworthy

0481996794

david.goldsworthy@raywhite.com