

FLOOR PLAN

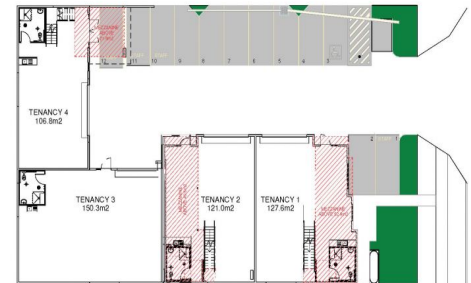

2/25 Hancock Way, Baringa QLD 4551

## Boutique Complex - Functional Warehouse

Samuel Hoy and David Goldsworthy from Ray White Commercial Northern Corridor Group is excited to present unit 2/25 Hancock Way for lease.

The last remaining site on Hancock Way provides an excellent opportunity for businesses to capitalise on an established street that is supported by a great range of businesses.

### FEATURES:

- 170m<sup>2</sup>\* warehouse (49.6m<sup>2</sup> mezzanine)
- Established and busy street
- Ample on-site and street car parking
- Transparent roof light
- Boutique development

Industrial  
FOR LEASE

170sqm

**Ray White**

**Samuel Hoy**

0423795273

samuel.hoy@raywhite.com

**David Goldsworthy**

0481996794

david.goldsworthy@raywhite.com