

38 - 40 Hindley Street, Adelaide  
 ESTIMATED GROSS LETTABLE AREA RETAIL  
 ■ 38 Hindley Street - First Flr: 168 sq. metres  
 Complies with the PCA Method of Measurement  
 (Scale in metres)

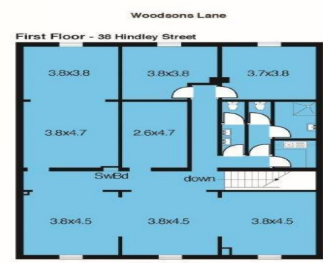

## Level 1/38-40 Hindley Street, Adelaide SA 5000

### Character office accommodation filled with natural light

168m<sup>2</sup> Office  
 Bathroom and Kitchen  
 Disabled Access via Chair Lift

Offices  
 FOR LEASE

168sqm

The premises offers an adaptable floor plan allowing for large open office space or smaller individual offices. Male and female toilets are centrally located with shower facilities also provided. The kitchen area has good storage space and a chair lift is provided for disabled access.

Rental: \$37,500 pa gross plus GST  
 Lease Term: Negotiable  
 Options: Negotiable  
 Rent Reviews: Negotiable