

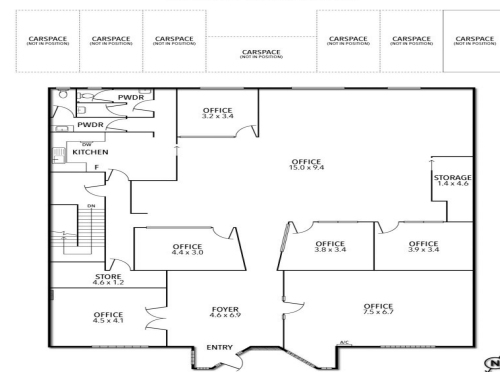

1/726 HIGH STREET, KEW EAST



1/726 High Street, Kew VIC 3101

MUST BE LEASED | Top Floor Corporate Office

RENTAL INCENTIVES AVAILABLE - LANDLORD OPEN TO OFFERS!
SHORT TERM LEASE AVAILABLE

Light and bright office located in the heart of Kew East. Features include partitioned offices, open plan area and meeting room, along with kitchen and toilet amenities within the tenancy.

7 onsite car spaces along with ample on street parking and public transport options for staff and clientele.

Close to major Eastern Arterials.

Inspect today to see if this could be suitable for your use.

? Building area | 320sqm

? Office partitioning

? Kitchen & toilet amen

Offices

FOR LEASE

Price Upon Application

320sqm

Ray White®

Brett Diston

0439365532

brett.diston@raywhite.com

Cameron Barber

0431 176 786

cameron.barber@raywhite.com