

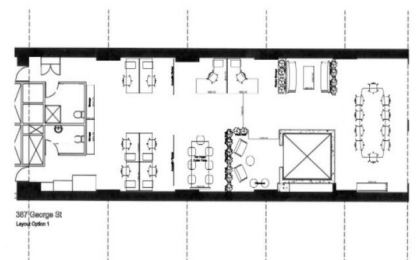

387 George St
Lapad types 2



Level 7/387 George Street, Sydney NSW 2000

Polished concrete floors

Situated on the light rail line. 387 George Street offers whole floor suites, bright outlook overlooking the Strand Arcade and Pitt Street Mall, high ornate ceilings, brilliant lift lobby with intercom access available, storage, air conditioned and own kitchenette, toilets and shower

- Polished concrete floors, dual bay windows, high ceilings
- Fitted with large boardroom, room for 14 workstations
- Own toilets, shower & kitchenette on floor

Offices

FOR LEASE

Please call for pricing
145sqm

Ray White

Marcus Plummer

mplummer@raywhite.com

Anthony Harris

aharris@raywhite.com