

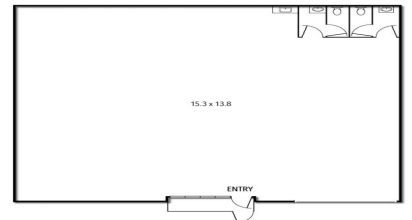

5/31 RUSHDALE STREET, KNOXFIELD



5/31 Rusdale Street, Knoxfield VIC 3180

Industrial Investment To Rush For

Ray White Commercial proudly presents this versatile entry level warehouse.

Offered with 2 year Lease + 2 year Option, this property offers great access to the Eastern suburb's major arterials along with space that newer developments simply cannot match.

Open floor plan equals maximum flexibility.

Zoned Industrial 1 and suitable for a variety of uses (STCA).

- ? Returns \$22,659.96 pa net
- ? Building area | 211sqm approximately
- ? Zoning | Industrial 1
- ? 3 Phase power
- ? Ideal entry investment

Industrial
FOR SALE

211sqm

Ray White®

Brett Diston

0439365532

brett.diston@raywhite.com