



1-5 Cross Street, Pyrmont NSW 2009

Five Terrace Houses in Pyrmont For Lease, Various Usage

These historical terrace houses feature:

- * 1-5 Cross Street & 6-8 Scott Street Pyrmont
- * Approx. 330sqm
- * Dimensions 20m (Cross St) * 21m (Scott St) * 20m (Western Boundary)
- * 23m (Northern Boundary)
- * Mixed zone & various usage S.T.C.A
- * Internal walls can be removed to create a large structure
- * Five terrace houses together for lease

For detailed info, Please contact David 0492 92 9791.

Retail
FOR LEASE
Contact Agent
330sqm

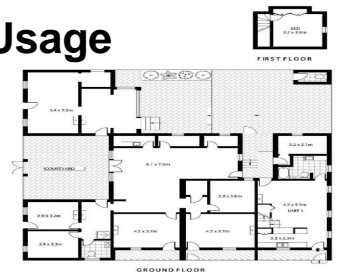

DRAKE
PROPERTY
9283 6280

David Shao

0492 929 791

david@drakeproperty.com