

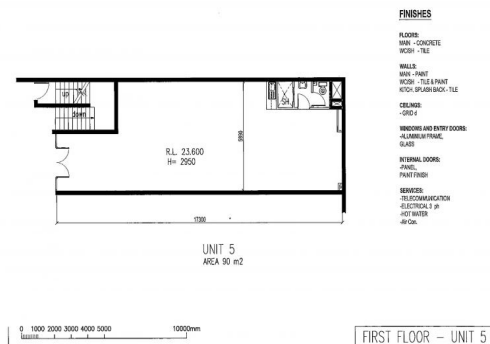

**More  
Photos  
Coming**



, Brookvale NSW 2100

## LEASED INVESTMENT

Located on the first floor of a security building is a beautifully fitted production suite located in the heart of Brookvale industrial precinct.

A few features are

- + Concrete floors
- + grid ceiling
- + Own amenities
- + Air conditioned
- + Security basement parking
- + Currently leased till Feb 2024

Industrial  
FOR SALE

90sqm