

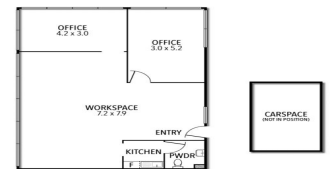

4/303 MAROONDAH HIGHWAY, RINGWOOD



4/303 Maroondah Highway, Ringwood VIC 3134

Light and Bright Ground Floor Office Suite

Take your business to the next level with this professionally presented and light filled ground floor office which could also be suitable for Medical or Consulting uses (STCA).

Features include air conditioning, two partitioned offices along with open area, and kitchenette and bathroom facilities.

Centrally located being close to Eastlink, a stone's throw from Ringwood Bypass and of course Maroondah Highway - it offers an excellent accessibility for staff or clientele alike.

Practicality is further enhanced with one onsite car space and a further permit for all day parking within the development included.

- ? Building area | 93sqm*
- ? Bathroom facilities
- ? Kitchenette facilitie

Offices
FOR LEASE

93sqm

Ray White®

Cameron Barber

0431 176 786

cameron.barber@raywhite.com