

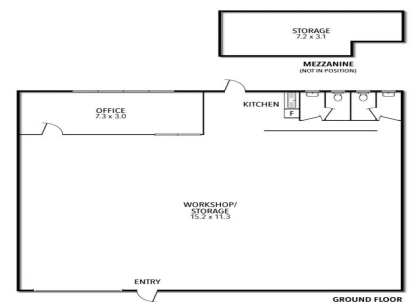

2/42 BURGESS ROAD, BAYSWATER NORTH



2/42 Burgess Road, Bayswater North VIC 3153

Entry Level Industrial - Occupy or Invest

RWC Diston Asset Services is pleased to offer for sale this excellent entry level factory in the heart of Bayswater North.

Situated in a block of 6 units, this development offers easy access onto Canterbury and Dorset Roads, both major arterials in this tightly held industrial area.

With dual bathroom amenities, kitchenette and an office area, it also offers practicality for your business needs.

Offered on flexible settlement terms.

? Building area | 216sqm approximately

? Zoning | Industrial 1

? Three phase power

? Lease expires 1st July 2024

Industrial

FOR SALE

216sqm

Ray White®

Brett Diston

0439365532

brett.diston@raywhite.com