

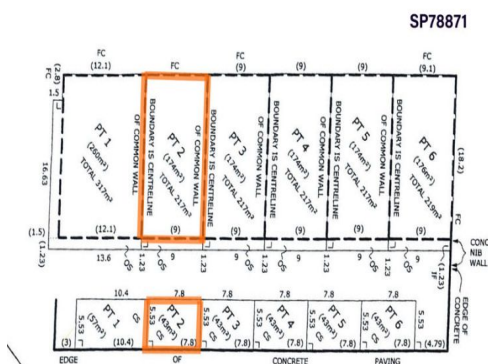

\* Indicative boundary only



## Unit 2/26 Industrial Drive, North Boambee Valley NSW 2450

### SUPERB INDUSTRIAL UNIT

Premium industrial unit with tilt slab construction, iron roof, high clearance roller door and 3-phase power.  
Convenient parking at the door with three (3) dedicated spaces.  
Quality facilities for this well kept strata unit.

Additional key featured include;

- 162sqm ground floor area plus parking of 76sqm plus large mezzanine floor area on one side
- Excellent condition, desirable strata unit in prime industrial precinct
- Currently let at \$600/week + outgoings, for approx. 6-months
- No option offered

For further details contact our exclusive sales a

Industrial

FOR SALE

\$545,000 (no GST)

162sqm

**Denis Gleeson**

0417 414 033

denis@theedgecommercial.com.au, a+2605@theedgecommercial.com.au, a+2605

**Kel Gibson**

0407 665 360